

Single Row Tapered Roller Bearing

31300 Series-31324XJ2

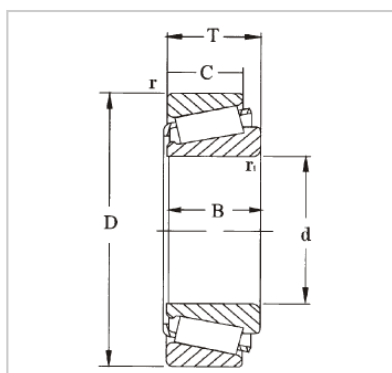

BEARING

WUXI GUANGQIANG BEARING TRADE CO.,LTD

Designação	31324XJ2
Dimensões principais (mm)	
d1	120
D	260
B	68
Classificações básicas de carga (KN)	
dyc (Cr)	539
stc (Cor)	695
Pu	73.5
Avaliações de velocidade (rpm)	
Classificações de velocidade	1700
Limitando a velocidade	2400
Peso (Kg)	15.5
ISO335	
Dimensões (ABMA)	7GB
Dimensões □mm□	
d	120
d1 □	190
B	62
C	42
r1,2 (min)	4
r3,4 (min)	3
uma	78
Dimensões de abutment e filete □mm□	
da (max)	145
db (min)	135
Da (min)	203
Da (max)	245
Db (min)	244
Ca (min)	9
Cb (min)	26
ra (max)	3
rb (max)	2.5
Valor	
e	0.83
Y	0.72
Yo	0.4

GQZ high quality 31300 Series Single Row Tapered Roller Bearing

Tapered roller bearings have tapered inner and outer raceways and rollers to handle simultaneous radial and thrust loads. Their axial load carrying capacity is directly related to the contact angle of the rollers and raceway shaft.

They are available in single-row, double-row, and four-row designs. The individual parts of tapered roller bearings are commonly sold separately as cups and cones. Cones contain the roller assembly and inner ring while cups include the outer ring. Full assembly units contain both the cup and cone. As separable bearings, different designs and sizes are available to accommodate a variety of applications.

Wuxi Guangqiang Bearing Trade Co.,Ltd-Tel:86-510-82601571-Email:gq@gqbearing.com,shary@gqbearing.com-http://www.bearing-asia.com